

## Technical factsheet

---



### Washstand

**WT.RX400.KE**

**KE series (Unisono)**

Item Number:

4506500000

## Characteristics

---

Model description	WT.RX400.KE
Item Number	4506500000
Material basin	glazed steel white
Coating	ProShield
Dimensions	w/h/d 400 mm/900 mm/442 mm
Form	round
Hole	without tap hole
Overflow	without overflow
Basin mould	round centred Bowl depth 394 mm
Net weight	20,5 kg
Mounting type	floor-standing

### Fittings information

Impact area 147 mm - 192 mm  
from rear edge of basin

Optimal impact on the basin mould with fittings that have a vertical outlet (90 ° angle of impact) and a built-in aerator.

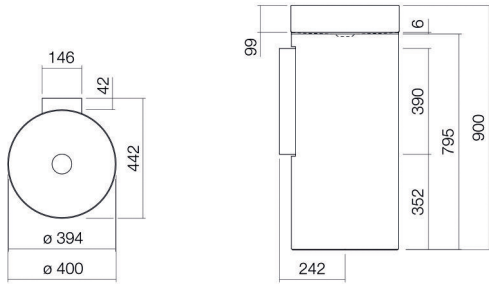

## Flow rate chart

## Product/tender specifications

**Washstand**  
**WT.RX400.KE**  
**KE series (Unisono)**  
Item Number:

4506500000

### Text

Washstand, floor-standing, round, w/h/d 400/900/442 mm, sink round, centred, w/h/d 394/99/394 mm, glazed steel, white, ProShield, without tap hole, without overflow, included fixing set, drain valve, valve cap, chrome-plated, Ø 74 mm, bottle trap, chrome-plated spacer ring, white wall bracket

---