

Technical factsheet



Washstand

WT.RX400K

K series

Item Number: 4503000401

Characteristics

Model description	WT.RX400K
Item Number	4503000401
Material basin	glazed steel white
Coating	antibacterial
Dimensions	w/h/d 404 mm/900 mm/444 mm
Form	round
Hole	without tap hole
Overflow	without overflow
Basin mould	round centred Bowl depth 359 mm
Net weight	16,5 kg
Mounting type	floor-standing

Fittings information Impact area 152 mm - 192 mm
from rear edge of basin

Optimal impact on the basin mould with fittings that have a vertical outlet (90 ° angle of impact) and a built-in aerator.

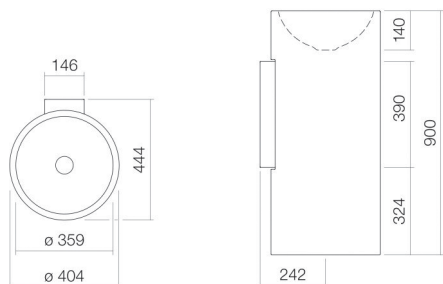

Flow rate chart

Product/tender specifications

Washstand
WT.RX400K
K series
Item Number:

4503000401

Text

Washstand, floor-standing, round, w/h/d 404/900/444 mm, sink round, centred, w/h/d 359/140/359 mm, glazed steel, white, antibacterial, without tap hole, without overflow, included fixing set, drain valve, valve cap, chrome-plated, Ø 63 mm, bottle trap, white wall bracket
