

Technical factsheet



Washplace

SET.WP.PN1

PN-series (Piccolo Novo)

Item Number: 0613001083

Characteristics

Model description	SET.WP.PN1
Item Number	0613001083
Material basin	glazed steel white
Coating	ProShield
Dimensions	w/h/d 555 mm/597 mm/320 mm
Form	rectangular
Hole	with one tap hole
Overflow	without overflow
Net weight	10,5 kg
Mounting type	wall-hanging

Fittings information

Impact area 121 mm - 151 mm
from middle of tap hole

Optimal impact on the basin mould with fittings that have a vertical outlet (90 ° angle of impact) and a built-in aerator.

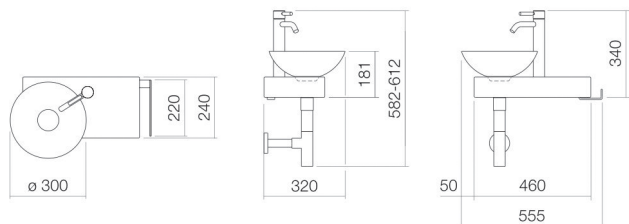

Flow rate chart

Product/tender specifications

Washplace

SET.WP.PN1

PN-series (Piccolo Novo)

Item Number:

0613001083

Text

Washplace, wall-hanging, rectangular, w/h/d 555/597/320 mm, dish basin, sink left, w/h/d 300/112/300 mm, glazed steel, white, ProShield, with one tap hole, right next to bowl, without overflow, bracket, steel, glazed, polished stainless steel, included fixing set, drain valve, valve cap, glazed in the basin colour, Ø 84 mm, chrome-plated bottle trap, single-lever basin mixer with raised base
